

## Environmental Evaluation of Flexible Housing

Dr. Jaume Avellaneda, Susana Dorantes, Dr. Josep Maria González, Katarina Mrkonjic

Technical University of Catalonia (UPC)

Barcelona, Spain

Contact: katarina.mrkonjic@upc.edu

5th BMBF Forum for Sustainability. Research for Sustainability - Driver for Innovation. 23 - 25 September 2008, ewerk, Berlin

### Introduction

Flexibility in use of dwellings can be an important factor for reducing the negative environmental impact, and indicators that reflect this fact should be looked for and used



Environmental Evaluation of Flexible Housing

J. Avellaneda, S. Dorantes, J. M. González, K. Mrkonjic

### 3 case studies

Unit A – “60 dwellings in La Roca del Vallès”, Spain, by Naxal Arquitectura S.L.  
**Particions of perforated bricks** (apr. 40m2 excl. bathroom+kitchen)

Unit B – “60 dwellings in La Roca del Vallès”, Spain, by Naxal Arquitectura S.L.  
**Particions of demountable wooden frames + cladding** (apr. 40m2 excl. bathroom+kitchen)

Unit C – “Optibo”. Göteborg, Sweden, by White Design  
**Transformable floors** (apr. 20m2 excl. bathroom)

Unit A and B

Unit C

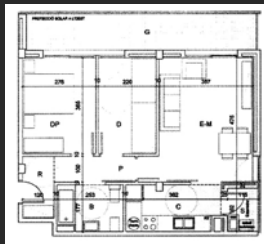

Environmental Evaluation of Flexible Housing

J. Avellaneda, S. Dorantes, J. M. González, K. Mrkonjic

### Material characteristics



#### Unit A - fixed

perforated brick blocks (1cm mortar + 7 cm brick + 1 cm mortar)



#### Unit B - demountable

wooden frames + wooden cladding (wooden board 1,9cm + profiles 5cm x 5 cm + wooden board 1,9cm)



#### Unit C - flexible

double floor with integrated furniture: 60cm high, wooden ribs (15cm x 5cm) at distance of 1m + columns (15cm x 5cm x 40cm) each 2 meters. Wooden floor of 5cm thick boards

Environmental Evaluation of Flexible Housing

J. Avellaneda, S. Dorantes, J. M. González, K. Mrkonjic

## Environmental impact of used materials: basic values

	Weight (kg/m <sup>3</sup> )	Energy consumption in production (MJ/kg)	CO <sub>2</sub> (g/kg)	SO <sub>2</sub> (g/kg)	NO <sub>x</sub> (g/kg)	Water consumption (liter/kg)	Waste in production (g/kg)
Brick	1200	3	1900	2	17	520	87
Mortar	1900	1	98	0,8	11	170	17
Wood	550	3	116	1	1	330	25
Steel	7500	25	2230	10	840	3400	601

Source:  
Bjorn Berge. *Ecology of Building Materials*. Architectural Press, 2001

## Results

	kg	Energy consumption in production (MJ/kg)	CO <sub>2</sub> (t)	SO <sub>2</sub> (kg)	NO <sub>x</sub> (kg)	Water consumption (t)	Waste in production (kg)
<b>TYPE A</b>							
Brick	1.779	5337,00	3,38	3,56	30,24	925,08	154,77
Mortar	1.307	1307,34	0,13	1,05	14,38	222,25	22,22
total		6644,34	3,51	4,60	44,62	1147,33	177,00
total/m <sup>2</sup>		160,220	0,085	0,111	1,076	27,666	4,288
%		100,00	100,00	100,00	100,00	100,00	100,00
<b>TYPE B</b>							
Wood	1.668	5002,80	0,19	1,67	1,67	550,31	41,69
total/m <sup>2</sup>		120,637	0,005	0,040	0,040	13,270	1,005
%		75,294	5,514	36,222	3,737	47,964	23,554
<b>TYPE C</b>							
Steel	50	1256,25	0,11	0,50	42,21	170,85	30,20
Wood	699	2095,50	0,08	0,70	0,70	230,51	17,46
total		3351,75	0,19	1,20	42,91	401,36	47,66
total/m <sup>2</sup> real		167,59	0,0097	0,06	2,15	20,07	2,38
%		104,598	11,412	54,091	199,380	72,535	55,836
total/m <sup>2</sup> virtual		83,794	0,005	0,030	1,073	10,034	1,192
%		52,299	5,706	27,045	99,690	36,267	27,918

## Results

- Results given per square meter, show that the Unit C, was the one with the highest impact in 2 parameters, while in the others was lower than the brick walls but higher than the wooden ones
- Virtual Unit C = Unit C x 2 = 20m<sup>2</sup> x 2 = 40m<sup>2</sup>
- Virtual Unit C's impact was lower (except for NO<sub>x</sub>) than the one of Unit A and B

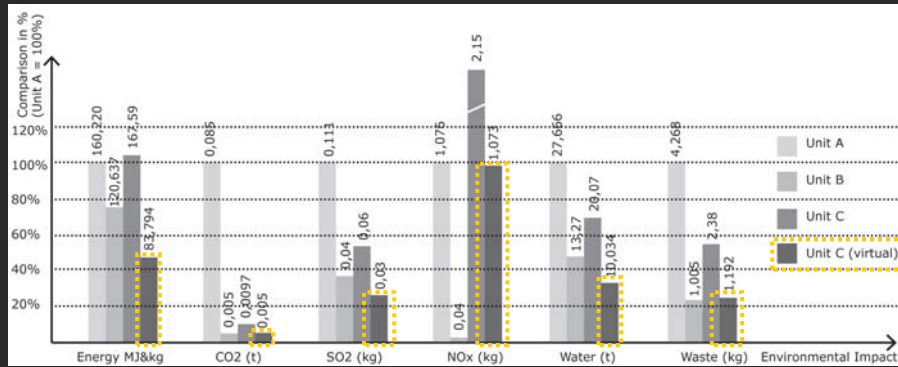

Environmental Evaluation of Flexible Housing

J. Avellaneda, S. Dorantes, J. M. González, K. Mrkonjic

## Conclusions

- **calculating the virtual surface that takes into account the flexibility helps us to get a more realistic picture of benefits of flexible dwelling from an environmental point of view**

Small, but flexible and transformable dwellings :

- **are** justified from the environmental point of view, even though in absolute numbers, per square meter, their impact can be higher than in some types of conventional dwellings
- may imply less need for heating/cooling energy, reduced use of construction materials
- imply higher housing density which leads to minimization of need for transportation, infrastructure etc.

Environmental Evaluation of Flexible Housing

J. Avellaneda, S. Dorantes, J. M. González, K. Mrkonjic

Thank you for your attention